



**THE RESORT**

JEBEL ALI BEACH  
DUBAI

FACTSHEET



# ONE MILLION SQUARE METRES OF UNIQUE MEMORABLE EXPERIENCES

**JA The Resort is home to  
three iconic hotels:**

JA Beach Hotel, JA Palm Tree Court  
and JA Lake View Hotel.

The resort comprises an area of 1 million  
square metres and has 25 restaurants  
and over 40 experiences.



STAY



## JA PALM TREE COURT

TRULY SERENE BEACHFRONT VILLA SUITES

212 suites

- **88 Garden View Junior Suites - 60m<sup>2</sup>**  
Accommodates up to 2 adults, 2 children & 1 infant
- **36 Sea View Junior Suites - 60m<sup>2</sup>**  
Accommodates up to 2 adults, 2 children & 1 infant
- **22 Garden Terrace Suites - 62m<sup>2</sup>**  
Accommodates up to 2 adults, 2 children & 1 infant
- **22 Premium Garden Terrace Junior Suites - 62m<sup>2</sup>**  
Accommodates up to 2 adults, 2 children & 1 infant
- **24 Beachfront Terrace Junior Suites - 62m<sup>2</sup>**  
Accommodates up to 2 adults, 2 children & 1 infant
- **8 Sea View Residence Junior Suites - 60m<sup>2</sup>**  
Accommodates up to 2 adults, 2 children & 1 infant  
Enhanced residence benefits
- **6 Sea View One Bedroom Suites - 120m<sup>2</sup>**  
Accommodates up to 2 adults, 3 children & 1 infant  
Enhanced residence benefits
- **4 Beachfront Residence One Bedroom Suites - 124m<sup>2</sup>**  
Accommodates up to 2 adults, 3 children & 1 infant  
Enhanced residence benefits
- **2 Sea View Residence Two Bedroom Suites - 210m<sup>2</sup>**  
Accommodates up to 4 adults, 3 children & 1 infant  
Enhanced residence benefits



STAY



## JA BEACH HOTEL

DUBAI'S FIRST RESORT

235 rooms & suites

- **169 Resort View and Sea View Rooms - 32m<sup>2</sup>**  
Accommodates up to 2 adults and 1 child
- **27 Deluxe Sea View Rooms - 38m<sup>2</sup>**  
Accommodates up to 2 adults and 1 child
- **15 Resort View Junior Suites - 64m<sup>2</sup>**  
Accommodates up to 2 adults, 1 child & 1 infant
- **8 One Bedroom Suites - 64m<sup>2</sup>**  
Accommodates up to 2 adults, 1 child & 1 infant  
Premium lounge benefits
- **12 Two Sea View Connecting Rooms - 64m<sup>2</sup>**  
Accommodates up to 2 adults, 2 children & 1 infant
- **4 Premium One Bedroom Suites - 122m<sup>2</sup>**  
Accommodates up to 2 adults & 2 children  
Premium lounge benefits



**STAY**



## JA LAKE VIEW HOTEL

THE LIFESTYLE HUB OF THE RESORT

### 348 rooms & suites

- **159 Deluxe Rooms - 40m<sup>2</sup>**  
Accommodates up to 2 adults, 1 child & 1 infant
- **71 Resort Course View Rooms - 40m<sup>2</sup>**  
Accommodates up to 2 adults, 1 child & 1 infant
- **57 Premium Resort Course View - 40m<sup>2</sup>**  
Accommodates up to 2 adults, 1 child & 1 infant
- **10 Junior Suites - 70m<sup>2</sup>**  
Accommodates up to 2 adults, 2 children & 1 infant
- **7 Resort Course One Bedroom Suites - 132m<sup>2</sup>**  
Accommodates up to 2 adults, 2 children & 1 infant
- **18 One Bedroom Terrace Suites - 168m<sup>2</sup>**  
Accommodates up to 2 adults, 2 children & 1 infant
- **4 One Bedroom Private Pool Suite - 168m<sup>2</sup>**  
Accommodates up to 2 adults, 2 children & 1 infant
- **2 Two Bedroom Outdoor Jacuzzi Suites - 250m<sup>2</sup>**  
Accommodates up to 4 adults, 2 children & 1 infant
- **20 Two Deluxe Connecting Rooms - 80m<sup>2</sup>**  
Accommodates up to 2 adults, 2 children & 1 infant



EAT



REPUBLIK



EIGHTY ONE (81)

# BRING OUT THE FOODIE IN YOU

## 25 restaurants & bars

**ANCHOR RESTAURANT:** JA Palm Tree Court  
Poolside restaurant serving snacks and refreshments

**ANCHOR POOL BAR:** JA Palm Tree Court  
Swim-up pool bar serving refreshments

**LA FONTANA BRASSERIE:** JA Palm Tree Court  
International buffet restaurant and French provencal dinner

**LA FONTANA POOL BAR:** JA Palm Tree Court  
Swim-up pool bar serving refreshments

**TAMR POOL & TERRACE:** JA Palm Tree Court  
Al fresco terrace serving seasonal delicacies  
*Exclusive for Palm Tree Court guests only*

**TAMR BAR:** JA Palm Tree Court  
Chic poolside bar serving snacks and refreshments  
*Exclusive for Palm Tree Court guests only*



EAT



KINARA



SETTE

## BRING OUT THE FOODIE IN YOU

25 restaurants & bars

**WHITE ORCHID RESTAURANT:** JA Palm Tree Court  
Contemporary South-East Asian cuisine

**WHITE ORCHID LOUNGE:** JA Palm Tree Court  
Signature cocktails

**EIGHTY ONE (81):** JA Lake View Hotel  
International buffet restaurant

**KINARA BY VIKAS KHANNA:** JA Lake View Hotel  
Speciality Indian restaurant led by Michelin star chef Vikas Khanna

**LAKESIDE CAFÉ:** JA Lake View Hotel  
Poolside snacks

**LOBBY LOUNGE:** JA Lake View Hotel  
Selection of beverages

**REPUBLIK:** JA Lake View Hotel  
Modern gastro pub



EAT



TAPERIA



VASCO DA GAMA

## BRING OUT THE FOODIE IN YOU

25 restaurants & bars

**THE VIBE:** JA Lake View Hotel  
Adults only poolside bar

**CAPTAIN'S RESTAURANT & BAR:** JA Beach Hotel  
Beachfront Mediterranean cuisine with wood fired pizza

**IBN MAJED:** JA Beach Hotel  
International buffet restaurant

**OASIS LODGE:** JA The Resort Golf Course  
Refreshments and snacks on the golf course

**PALMITO POOL BAR:** JA Beach Hotel  
Swim-up pool bar serving refreshments

**SANDBAR:** JA Beach Hotel  
Beach bar with a sandy terrace serving refreshments

**SETTE:** JA Beach Hotel  
Authentic Italian restaurant

**SETTE LOUNGE:** JA Beach Hotel  
Signature Italian lounge serving pre and post dinner drinks





EAT



WHITE ORCHID



SMOKIN' GUN

# BRING OUT THE FOODIE IN YOU

## 25 restaurants & bars

**SIGNATURE LOUNGE: JA Beach Hotel**  
Exclusive lounge overlooking Signature Pool serving refreshments and snacks

**SUNRISE LOUNGE: JA Lake View Hotel**  
Tea lounge overlooking the beach and gardens

**SUNSET LOUNGE: JA Beach Hotel**  
Tea lounge overlooking the beach and gardens

**SMOKIN' GUN: JA Shooting Club**  
Over-the-top burgers and top-notch shakes

**SPORTS CAFÉ: Club Jumana**  
European pub grub overlooking JA Marina

**STABLES COFFEE STOP: JA Equestrian Centre**  
Refreshments and snacks at JA Equestrian Centre

**TAPERIA: JA Beach Hotel**  
Tapas Restaurant with Traditional Spanish Favourites

**VASCO DA GAMA: JA Beach Hotel**  
Ideal place for drinks and live entertainment



PLAY



## THERE IS FUN,

- 800 metres of private beach
- 8 temperature-controlled swimming pools with swim-up bars
- 9-hole, par 35, championship standard golf course with floodlit driving range, putting and pitching greens
- JA Golf Academy Dubai
- Horse riding stables with instructors
- 4 floodlit tennis courts, squash court and badminton court
- Beach volleyball facilities
- 9-hole mini-golf course
- JA Shooting Club features international standard indoor and outdoor shooting
- 2 Padel tennis courts
- Aviaries with bird shows
- Calm Spa & Salon offering over 40 rejuvenating treatments and services
- Animal Discovery Zone



PLAY

## AND THERE IS MORE FUN

- Private 100-berth full-service marina
- Speciality shops
- Bio-garden with greenhouses for fresh herbs & vegetables
- Watersports centre providing kayaking, SUP boarding, wakeboarding and wakesurfing
- Zumba classes
- Beach volleyball
- Football tournaments
- Billiard games
- Darts tournaments
- Table tennis



## FOR THE LITTLE ONES

- 3 temperature-controlled children's and toddlers' pools
- Crèche (4 months to 23 months)
- Pirates & Mermaids Kids Club (4 years to 12 years)
- Babysitting service available on request
- Kids cooking classes
- Family movie nights
- Kids disco nights



### RESTAURANTS & BARS

- 1 Anchor Restaurant & Bar
- 2 Captain's Restaurant & Bar
- 3 Sunrise Lounge
- 4 81
- 5 Vibe Bar
- 6 Ibn Majed
- 7 Sette
- 8 Sette Lounge
- 9 Kinara by Vikas Khanna
- 10 La Fontana Brasserie
- 11 La Fontana Pool Bar
- 12 Lakeside Café
- 13 Vasco Da Gama
- 14 Oasis Lodge
- 15 Palmito Pool Bar
- 16 Republik
- 17 Smokin' Gun
- 18 Sports Café
- 19 Stables Coffee Stop
- 20 Sunset Lounge
- 21 Taperia
- 22 White Orchid Restaurant
- 23 White Orchid Lounge
- 24 Soul Beach
- 25 Sandbar
- 26 Tamr Terrace
- 27 Tamr Pool & Bar
- 28 Bibe Rooftop Lounge
- 29 JA Splash Pool Bar

### EXPERIENCES

- 1 JA Marina
- 2 JA The Resort Golf Course & JA Golf Academy
- 3 JA Equestrian Centre
- 4 JA Sports Centre & JA Shooting Club (archery, football, cricket, rugby, paintballing) - 3 min drive from the Resort)
- 5 Signature Pool
- 6 La Fontana Pool
- 7 Anchor Pool
- 8 Palmito Pool
- 9 Main Beach
- 10 Watersports Centre
- 11 Signature Lounge
- 12 Calm Spa & Salon
- 13 Mini Golf
- 14 Kids Playground
- 15 Beach Volleyball
- 16 Pirates & Mermaids Kids Club
- 17 Just Splash splash park
- 18 Just Splash splash pad
- 19 Club Jumana (gym, squash, badminton, table tennis)
- 20 Tennis Courts + Padel Tennis Courts
- 21 Bio Garden
- 22 Bird Aviaries
- 23 Animal Discovery Zone
- 24 JA Splash Pool

### BUGGY STOPS

- 1 JA Lake View Hotel
- 4 JA Beach Hotel
- 2 JA Equestrian Centre
- 5 Pool & Beach Entrance
- 3 JA Palm Tree Court
- 6 Club Jumana

### HOTELS & ACCOMODATION

- 1 JA Palm Tree Court Villa 1
- 2 JA Palm Tree Court Villa 2
- 3 JA Palm Tree Court Villa 3
- 4 JA Palm Tree Court Villa 4
- 5 JA Palm Tree Court Villa 5
- 6 JA Palm Tree Court Villa 6
- 7 JA Palm Tree Court Villa 7
- 8 JA Palm Tree Court Villa 8
- 9 The Residence Suites Villa 9
- 10 JA Palm Tree Court Villa 10
- 11 JA Palm Tree Court Lobby
- 12 JA The Resort Entrance
- 13 JA Beach Hotel
- 14 JA Lake View Hotel

### FACILITIES

- 1 Guest Transportation Path
- 2 Walking Track
- 3 Shopping Arcade
- 4 Conference Centre
- 5 Library
- 6 Mosque
- 7 Car Park
- 8 Palmito Garden
- 9 Amphitheatre
- 10 Croquet Lawn

# THE PURSUIT OF DIFFERENTIATION

## VENUES

- Dividable meeting spaces
- Separate entrance to conference centre
- Advanced audio visual technology
- Spacious outside terrace
- Free Wi-Fi in public areas & all meeting rooms
- Valet parking

### JA BEACH HOTEL

INDOOR VENUES	WIDTH METRES	LENGTH METRES	HEIGHT METRES	SQUARE METRES	THEATRE	U-SHAPE	CLASSROOM	CABARET	BOARDROOM	BANQUET	RECEPTION
Al Saadiyat	9.5	15	3.5	142.5	80	30	35	42	30	60	100
Al Habab	10	15	3.5	150	80	30	35	42	30	60	100
Al Hassah	8.4	14.2	3.5	119.2	40	20	20	28	20	40	-
Al Ghubeiba	8.4	14.2	3.5	119.2	70	30	35	35	20	60	100
Hatta	6.9	13.5	2.5	98	50	-	-	-	20	-	-
Al Saadiyat & Habab	19.5	15	3.5	292.5	160	60	70	100	60	120	200
Al Hassah & Ghubeiba	16.8	14.2	3.5	238.5	120	60	50	60	40	80	150
Al Hassah & Ghubeiba & Habab	24.2	16.8	3.5	566	120	80	100	120	80	160	250
Al Wasl Ballroom	33.7	20	3.5	560	500	90	180	180	-	270	600
OUTDOOR VENUES	WIDTH METRES	LENGTH METRES	HEIGHT METRES	SQUARE METRES	THEATRE	U-SHAPE	CLASSROOM	CABARET	BOARDROOM	BANQUET	RECEPTION
Al Wasl Terrace 1	11	20	-	220	-	-	-	-	-	80	200
Al Wasl Terrace 2	25	15	-	375	-	-	-	-	-	140	300
Croquet Lawn	15	35	-	525	-	-	-	-	-	180	250
Palmito Garden	25	50	-	1250	-	-	-	-	-	1000	1500
Amphitheater	9	9	-	81	-	-	-	-	-	-	90
Soul Beach	40	40	-	1600	-	-	-	-	-	1000	1800

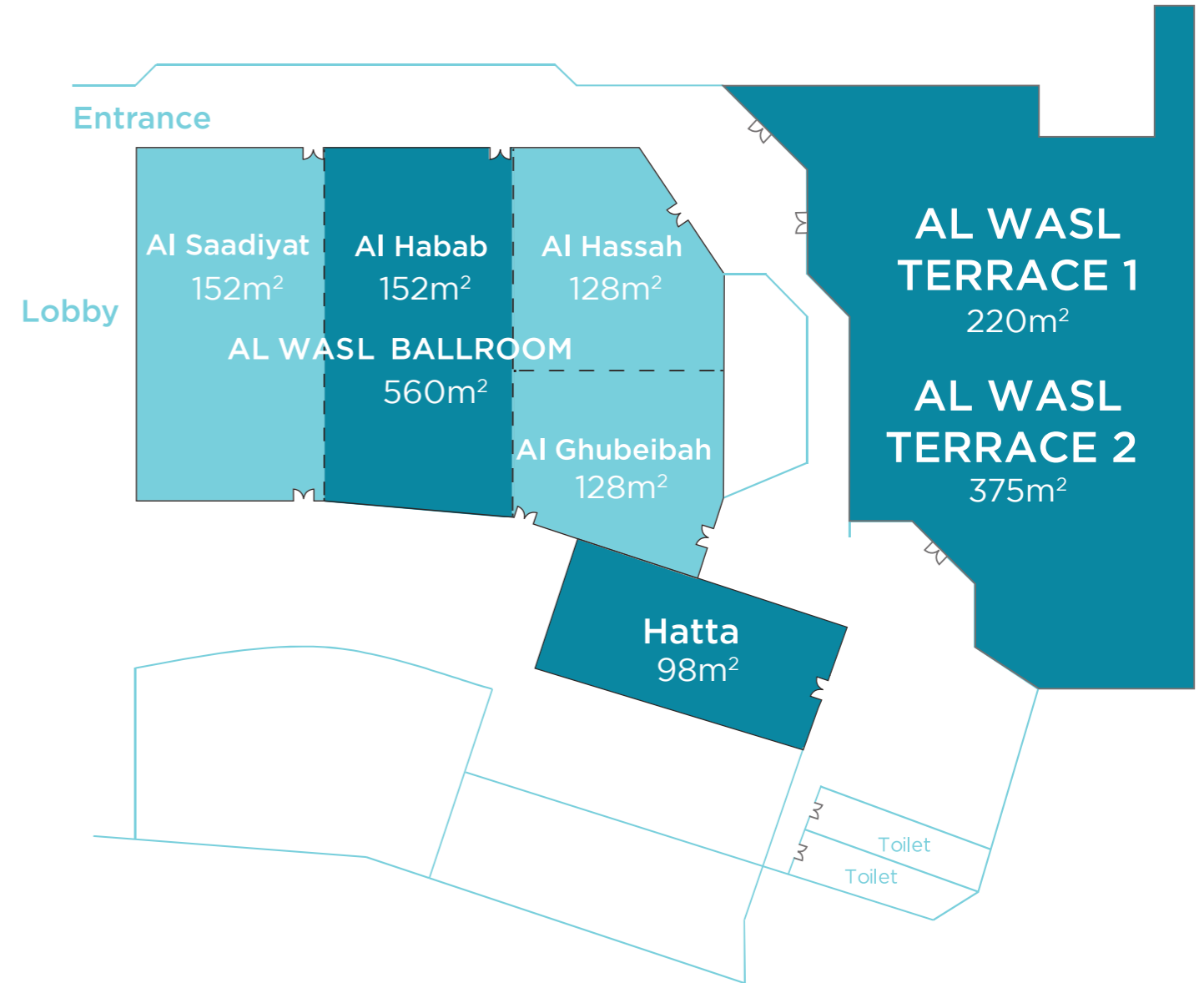

# VENUES

- State of the art meeting rooms
- Natural daylight
- Modern design
- Wi-Fi in public areas and all rooms
- Valet parking available

## JA LAKE VIEW HOTEL

INDOOR VENUES MEETING ROOMS	SQUARE FEET	SQUARE METRES	THEATRE	U-SHAPE	CLASSROOM	CABARET	BOARDROOM	BANQUET	RECEPTION
Air	512	47.6	48	16	16	-	16	-	50
Sky	506	47	30	14	12	-	12	-	-
Water	494	45.9	30	17	18	-	12	-	-
Earth	247	22.9	-	-	-	-	10	-	-
Fire	1159.9	107.8	60	30	35	42	-	60	80
Moon	426	39.5	30	-	12	-	12	-	-
Air + Sky	1012.3	94	60	-	-	-	30	-	-

### EVENTS AT BIBÉ

Bibé Rooftop Lounge offers a breathtakingly panoramic view of JA The Resort Golf Course, designed by the famous Peter Harradine. This uniquely contemporary and elegant rooftop venue is a great option for intimate VIP functions and socials.

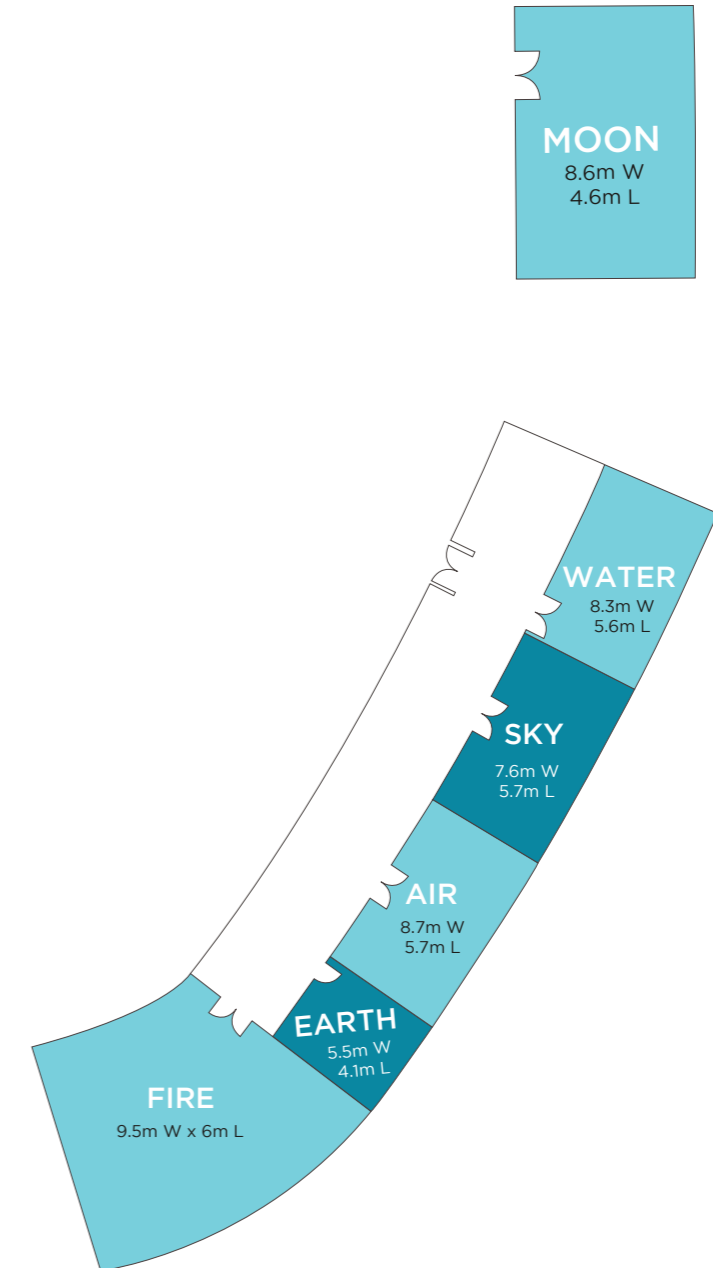

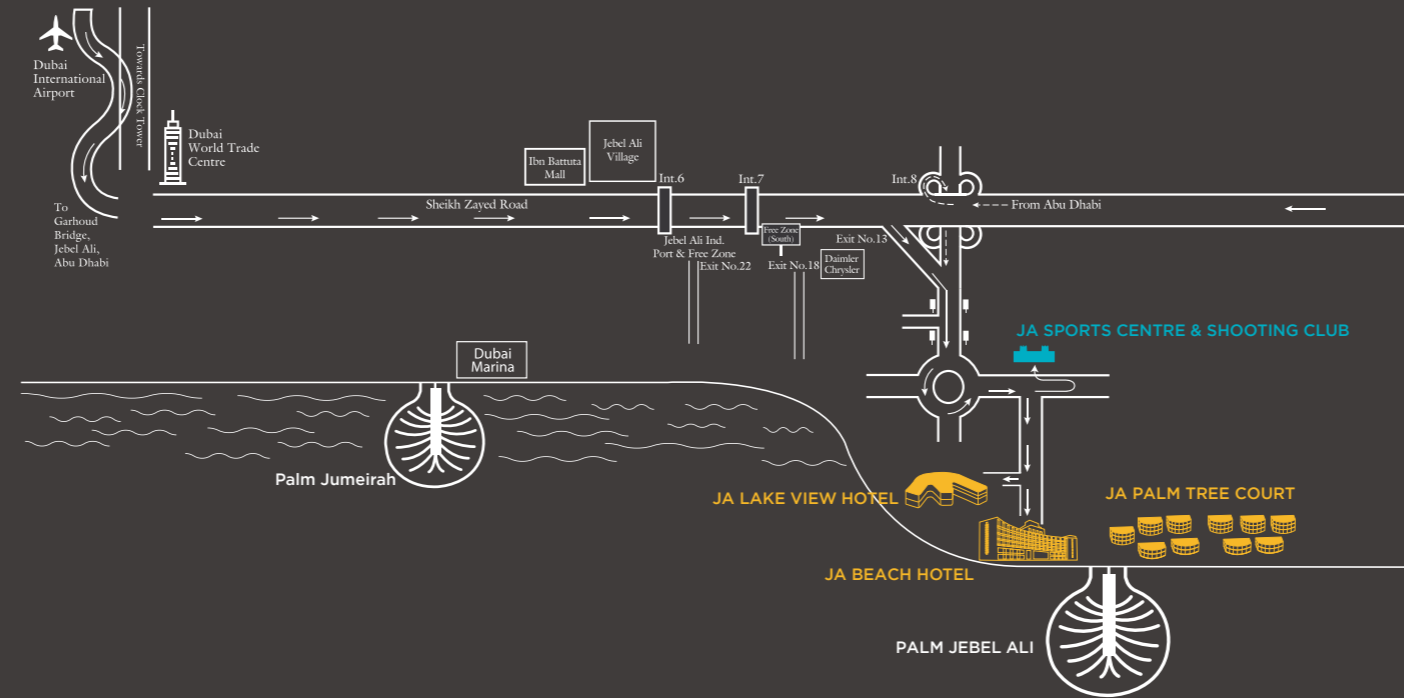

## FROM DUBAI INTERNATIONAL AIRPORT

Follow the Jebel Ali/Abu Dhabi signboards from the airport until you reach Sheikh Zayed Road. Continue straight for approximately 40km, and take Exit No. 13, which will direct you to the Jebel Ali Free Zone (JAFZA) towards gates 7, 8 and 9, and keep right.

Remain on this road and proceed through the traffic light intersection until you approach the initial roundabout, and turn left. JA Sports Centre & Shooting Club will be on your left. Take the exit to the right which has the JA The Resort sign.

For access to JA Lake View Hotel, Club Jumana and Soul Beach, take the right turn before you reach the hotel's main entrance. For access to JA Beach Hotel and JA Palm Tree Court, continue straight until you reach the roundabout and the resort's entrance will be on the right.

## FROM ABU DHABI

When driving from Abu Dhabi, exit onto Interchange 8 and follow the slip road on the right heading towards the Jebel Ali Free Zone (JAFZA) gates 7 and 8.

Continue on this road and proceed through the traffic light intersection until you approach the initial roundabout, and turn left. JA Sports Centre & Shooting Club will be on your left. Take the exit to the right which has the JA The Resort sign.

For access to JA Lake View Hotel, Club Jumana and Soul Beach, take the right turn before you reach the hotel's main entrance. For access to JA Beach Hotel and JA Palm Tree Court, continue straight until you reach the roundabout and the resort's entrance will be on the right.



Address: P.O.Box 9255, JA The Resort, Exit 13, Sheikh Zayed Road, Jebel Ali, Dubai, UAE

For more information, get in touch with us on +971 4 814 5555  
or [reservations.jatheresort@jaresorts.com](mailto:reservations.jatheresort@jaresorts.com)

[JAresorts.com](http://JAresorts.com)

[f](#) JATHERESORT

[@](#) JATHERESORT